

Brimscombe Church of England Primary School



Brimscombe Hill
Brimscombe
Stroud
GL5 2QR
Tel: 01453 882474

E: admin@brimscombe.gloucs.sch.uk

Dear Dragonfly Class,

We have come to the end of our term and what a strange term it's been! Before I say anything else, I want you to know that I'm so proud of you and all your hard work and I'm thankful for the joy and laughter that you've brought to our classroom each and every day. It's important that you keep on learning, even though we are not together at school, and I know that you will show your grown-ups the same brilliant learning attitude that you show me at school every day.

Daily Timetable

To make sure that you have some structure to your day, here is a suggested timetable that you could use. It roughly fits what we have been doing in school but please feel free to change it around to fit your family.

8:00-9:00 Get up, get washed/dressed, eat breakfast etc.

9:00-10:00 Phonics/Writing

10:00-10:30 Fitness break – Run around the garden, do a fitness video on YouTube, do some yoga...

10:30-11:00 Reading

11:00-12:00 Maths

12:00-1:30 Lunch and Fitness Break

1:30-3:00 Dragonfly Home Learning Grid activities

Top Tips for learning

- Organise a working space.
- Get dressed for learning.
- Agree on a timetable and stick to it.
- Get plenty of fresh air breaks.
- Have water and snacks available.
- Limit screen time.
- Agree on possible rewards.
- Keep posting you work on Seesaw.



Brimscombe CE Primary School is committed to the protection and safeguarding of children

From Monday, I will be posting daily activities in Maths and Writing on SEESAW. There you will find activities linked to all the subjects in our curriculum. For parents who are not familiar, SEESAW is an interactive app which allows children/parents to log in to access activities and upload pictures remotely. Parents, please download the app onto a tablet or smartphone at home. Below is a screenshot of what the app looks like.

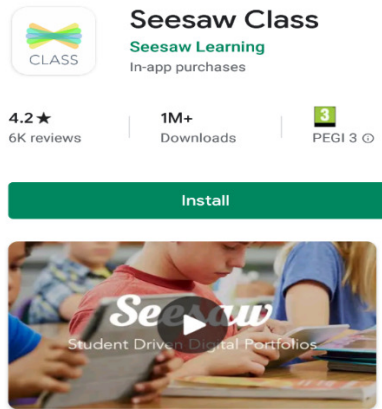

Work will be posted in the Activities Section of the app. The instructions and QR scanning code for the app are below. Once you have completed the work, please upload a picture of it and then store it in your individual named folders. I will then be able to approve it and comment on it. If you have any questions or are having any problems getting on to the app, please ask your parents to email me.

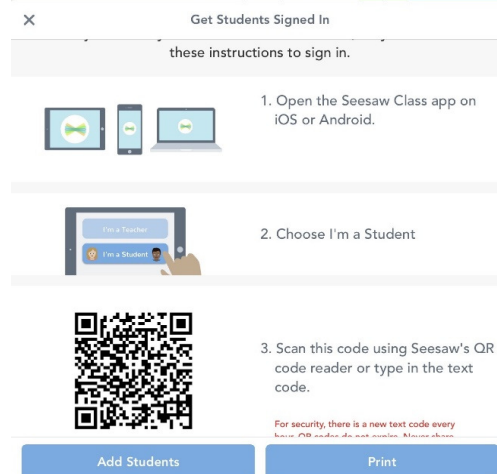

Alongside this, there is a brand new 'Dragonfly Home Learning Grid' for you to look at on the school website on our Dragonfly Class page. Please use these activities to make sure you do a broad range of things during each day and anything you do, even if it's not a set task, remember to upload it to seesaw so I can see what you're up to! I hope this is useful and please don't hesitate to contact me if you need anything. My email address is nbrown@brimscombe.gloucs.sch.uk.

Take care of yourselves and I look forward to seeing you all soon.

Mrs Brown



Brimscombe CE Primary School is committed to the protection and safeguarding of children